

Model #5

28x76 4-Sec Ranch 2,128 sq. ft.

Design Homes, Inc.

Fond du Lac, WI
 (#10445 -5-4)



Base Price: \$160,024.00

This Home Displays The Following Options:

6/12 Roof Slope	3,724.00
Large Gable	1,456.00
Premium Color Vinyl Siding	723.00
Window Lineals	649.00
Upgrade Carpet (Adaptation)	1,697.00
Vaulted Ceilings (Lr, Kit, Dining)	1,625.00
Java Bean Oak Trim and Doors	500.00
Interior French Doors w/Glass	1,185.00
Wire for Electric Range	100.00
Paddle Fan/Light (x2)	367.00
Laundry Area w/Benton Birch Cabs.	985.00
SS Laundry Sink/Faucet/Base Cab.	813.00
Extra 3/4 Bath	2,450.00
Double Sink Vanity	725.00
Nutone Medicine Cabinet upgrade (x3)	639.00
Shower Door (Bath #2)	285.00
Vanity Base Drawers (x3)	490.00
Hi-Rise Toilet (Bath #2)	215.00
Elongated Toilet (Bath #1)	62.00
Cult. Granite Vanity Top (Bath #2)	354.00
Benton Birch UMBER Cabinets	2,858.00
5 Pc. Drawer Fronts (Kit. Only)	412.00
SS Microwave (WMH310)	404.00
Base Waste Basket	214.00
Base Cabinet Drawer Base (x2)	92.00
Mullion Glass Cabinet Door	123.00
3' of Extra Wall Cabinets	420.00
2' of Extra Base Cabinets	358.00
Crown Molding Above Kit Cabinets (28')	420.00
Kohler Pull-down Kit. Faucet (K560-CP)	215.00
Glass Walk-in Pantry Door	625.00
Suntubes (x3)	1,680.00
1' Bump-out LR Window	859.00
Pella Impervia Windows (Fiberglass)	4,510.00
6' Pella Impervia Patio Door	2,177.00
Window Grilles (Front only)	390.00
Sidelight (S692TRC)	887.00
Upgrade Entry Door (S684TRC)	516.00

Total With Options Shown: \$196,228.00

Feb. 2018

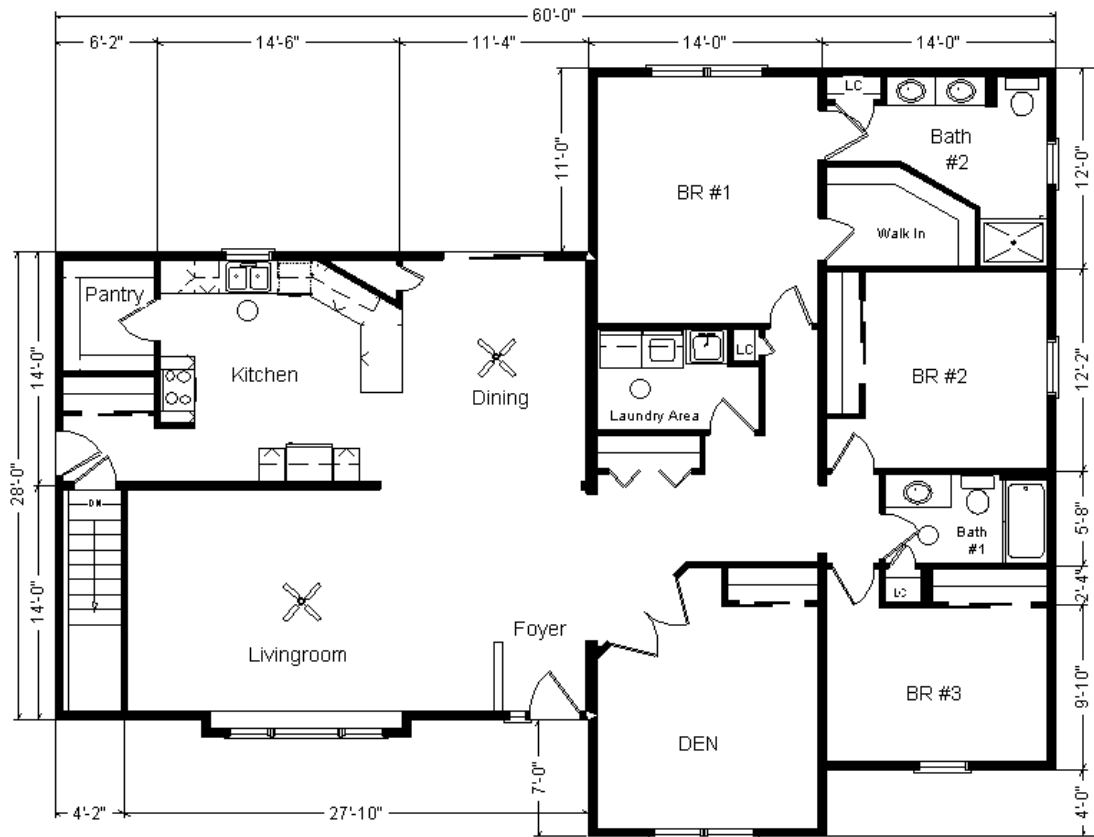

Color Information
 Spruce Dbl 4" Siding, White Trim, Weathered Wood Shingles,
 White Lineals, White Window Grilles, Bisque Baths, #430 Vanity Bath
 #2, Aged Leather Carpet, 9510 Vinyls, Java Bean Oak Trim & Doors,
 Pella Impervia White Dbl-hung Windows, SS Sink and Microwave,
 Mocha Travertine Countertop

MN #BC146710

Price Includes: Delivery in Zones 1 and 2, Crane Work, All Blueprints, R55 Ceilings, R20 Exterior Walls, REAL Plywood Floors, Kohler Plumbing, Pella Windows, 200 Amp Service, All Applicable Tax and Much More!!

Furnace and Duct Work Included and Installed in Zone 1 ONLY

ZONE 1

Reverse Plan

