

Design Homes, Inc.

Medford, MN
(#9914 -2-4)



Base Price:	\$118,942.00
This Home Displays The Following Options:	
6/12 Roof Slope	2,976.00
Large Gable	1,400.00
9' Ceilings (NOT in Sunroom)	3,212.00
1' Bump-Out Window (Bath #2)	500.00
Mastic Siding (disc.)	5,000.00
Peachtree Windows	4,400.00
Shutters	336.00
Upgrade Carpet (Winsford)	1,188.00
Tile Laminate (Kit, Din, Foyer)	2,573.00
Vaulted Ceilings (LR, DR, Kitchen)	1,550.00
Gas Fireplace	5,600.00
Upgrade 6 Panel Oak Doors (x13)	2,795.00
Interior French Doors w/Glass	1,185.00
Paddle Fan Light (LR)	204.00
Wire for Electric Range	100.00
Extra 3/4 Bath	2,450.00
Laundry Area w/SR Cabinets	1,145.00
Rubbed Bronze Package	1,165.00
Corner Whirlpool	3,200.00
Double Sink Vanity	725.00
Vanity Base Drawers (Bath #1)	132.00
Cultured Granite Vanity Tops	561.00
Shower Door (Bath #2)	285.00
Seneca Ridge Maple Cabinets	3,570.00
7.5' Extra Base Cabinets	1,470.00
6' Extra Wall Cabinets	882.00
Crown Molding Above Kit Cabinets (31')	496.00
3' Mullion Glass Doors	255.00
Kohler Cast Iron Sink	307.00
Pull-out Kit. Faucet (K12177-BRZ)	195.00
Whirlpool Dishwasher	574.00
Suntube (x3)	1,680.00
6' French Slide Patio Door (BR #1)	2,047.00
Upgrade Front Door (S684TRC)	516.00
Sidelight (S692TRC)	887.00
Home Total w/Options	\$174,503.00

14 x18 SR w/Gable Base Price	\$23,414.00
Vaulted Ceiling	527.00
Upgrade Carpet (Winsford)	308.00
Paddle Fan/Light	160.00
Mastic Siding (disc.)	720.00
6' French Slide Patio Door	2,047.00
Sunroom Total	\$27,176.00

Total With Options Shown: \$201,679.00

Model #4
28x62 Ranch w/SR 1,988 sq. ft.

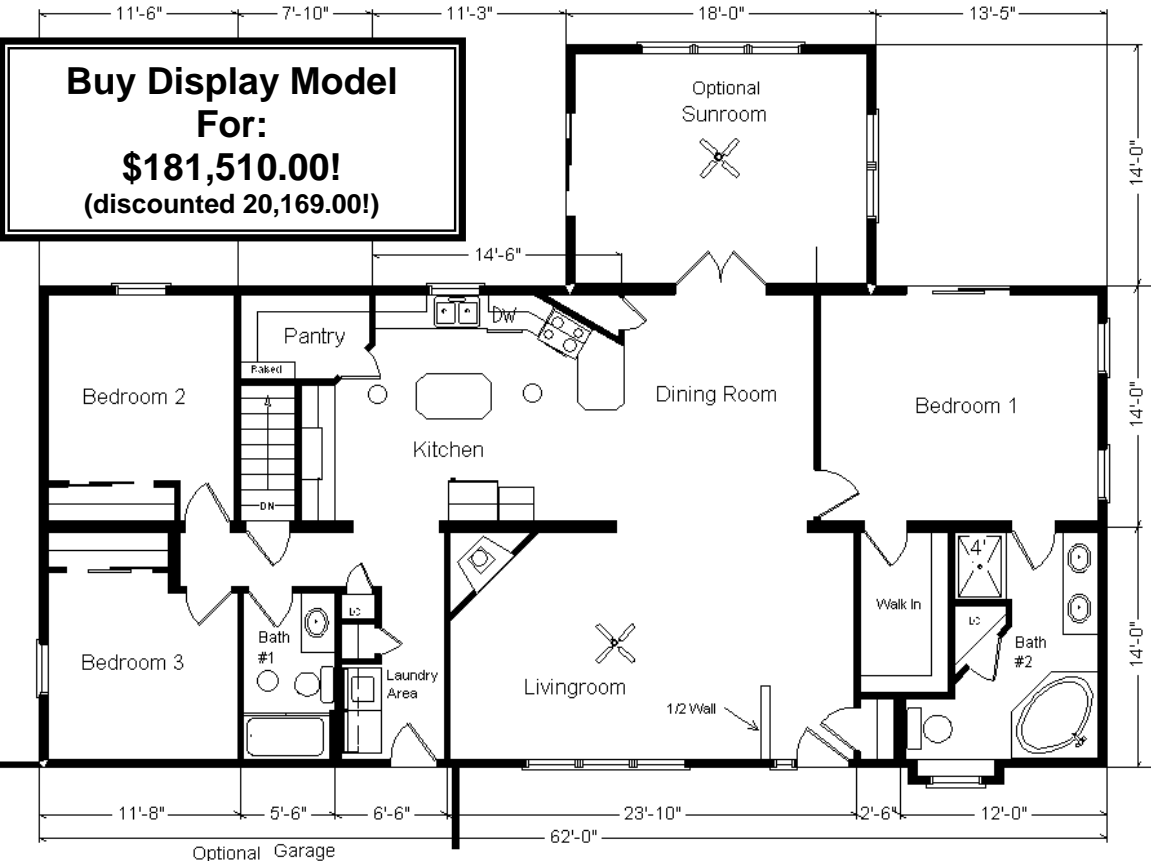

Color Information
 Timberstone Siding, White Trim, Heather Blend Shingles, White Shutters, Bisque Baths, #430 Vanity Tops, Rye Carpet, 91082 Vinyls, 159 Light Sepia Laminate, Bisque Kit. Sink, Natural Oak Trim & Doors, Black Dishwasher & Rangehood, Peachtree White Dbl-hung Windows w/Clear Pine Interiors, Butterum Granite Countertop, White FP Front

Price Includes: 100 Mile Delivery, Crane Work, All Blueprints, R55 Ceilings, R20 Exterior Walls, REAL Plywood Floors, Kohler Plumbing, Pella Windows, 200 Amp Service, All Applicable Tax and Much More!!

ZONE 1

MN #BC146710