

Base Price:	\$118,942.00
This Home Displays The Following Options:	
6/12 Roof Slope	2,976.00
Large Gable	1,400.00
Extra Gable Detail	209.00
1' Bump-Out Window (Bath #2)	500.00
White Lineals on Windows	697.00
Vinyl Shake Siding on Bump-out	133.00
Upgrade Carpet (EDL II)	2,487.00
Tile Laminate (Kit, Din.)	2,413.00
Vaulted Ceilings (LR, DR, Kitchen)	1,550.00
Gas Fireplace	5,600.00
Upgrade 6 Panel Oak Doors (x10)	2,150.00
Interior French Doors w/Glass	576.00
Paddle Fan Light (x2)	367.00
Wire for Electric Range	100.00
Extra 3/4 Bath	2,450.00
Laundry Area w/Cabinets	750.00
Brushed Nickel Package	1,165.00
Corner Whirlpool	3,200.00
Double Sink Vanity	725.00
Vanity Base Drawers (x3)	396.00
Cultured Granite Vanity Tops	590.00
Seneca Ridge Oak Cabinets	2,400.00
8.5' Extra Base Cabinets	1,369.00
7.5' Extra Wall Cabinets	923.00
Crown Molding Above Kit Cabinets (31')	496.00
Pull-out Kit. Faucet (K15160-BN)	195.00
5' Mullion Glass Door Wall Cabinets	425.00
Whirlpool Dishwasher (DU850)	504.00
Whirlpool Microwave (WMH2175)	414.00
Suntube (x4)	2,240.00
Pella Pro-Line Windows	5,699.00
Upgrade Front Door (S684TRC)	516.00
Sidelight (Full Glass)	599.00
Home Total w/Options	\$165,156.00
14 x18 SR w/Gable Base Price	\$21,914.00
Vaulted Ceiling	527.00
Upgrade Carpet (EDL II)	644.00
Paddle Fan/Light	163.00
Pella Pro-Line Windows	2,830.00
Peachtree Patio Door (700PS2)	1,798.00
Sunroom Total	\$27,876.00
Total With Options Shown:	\$193,032.00

Zone 2

Design Homes, Inc.

Missouri Valley, IA
(#9929 -2-4)



MN #BC146710

Model #5
28x62 Ranch w/SR 1,988 sq. ft.

Buy Display Model For:
\$173,729.00!
(discounted 19,303.00!)

Color Information
Sterling Gray Sidings, White Trim, White Corner Posts, Driftwood Shingles, White Lineals, White Baths, #430 Vanity Tops, Parchment Carpet, DF9320 Vinyls, 775 Berkeley Laminate, SS Kit. Sink, Nutmeg Oak Trim & Doors, Black Dishwasher & Microwave, Pella White Dbl-hung Windows/Nutmeg Interiors, Mocha Travertine Countertop, Green FP Front

Jan 2017

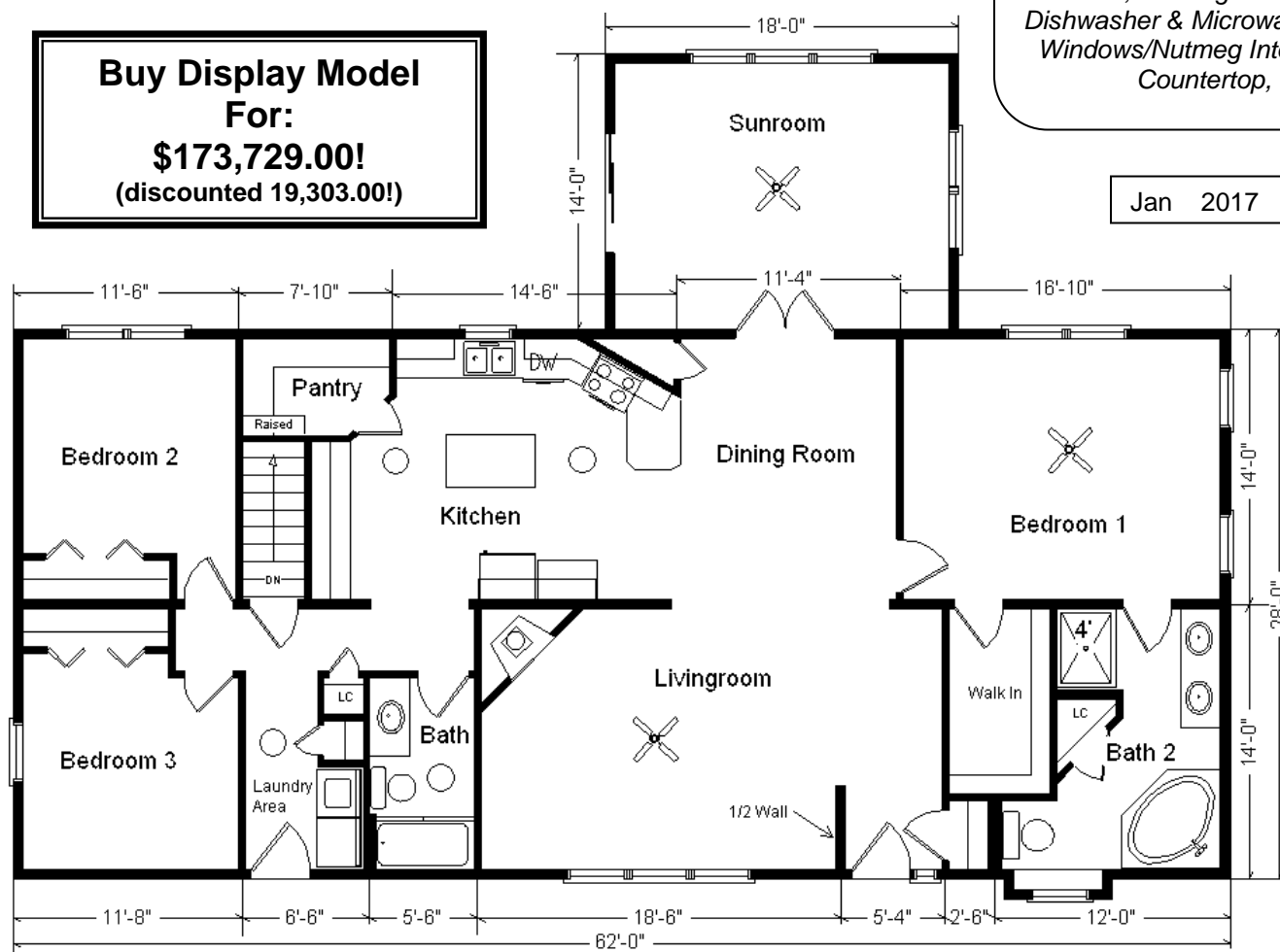

Price Includes: 100 Mile Delivery, Crane Work, All Blueprints, R55 Ceilings, R20 Exterior Walls, REAL Plywood Floors, Kohler Plumbing, Pella Windows, 200 Amp Service, All Applicable Tax and Much More!!