

Model #6

28x62 Ranch w/SR 1,988 sq. ft.

Design Homes, Inc.

Salix, IA
 (#1277 -3-5)



Base Price: \$94,314.00

This Home Displays The Following Options:

* 6' Roof Rise (4.68/12 Slope)	2,046.00
* Crestline Windows (unfinished)	850.00
Large Gable	1,074.00
Extra Roof Detail	193.00
Upgrade Carpet (WL)	969.00
Wood-look Laminate Floor (FR)	840.00
Tile-look Laminate in Foyer	98.00
Wood Fireplace	2,498.00
Vaulted Ceilings(LR, DR, Kitchen Fm Rm)	1,666.00
Oak Trim & Doors	1,150.00
Interior French Doors w/Glass	534.00
4' Flour. Kitchen Light	147.00
Paddle Fan w/Light	151.00
Tv/Phone Box	13.00
Extra 3/4 bath	1,839.00
Utility Room w/Northport Cabinets	695.00
Double Sink Vanity	565.00
6' Whirlpool	1,950.00
Oak Tri-view Med. Cabinets (x3)	360.00
Seneca Ridge Arch Maple Cabinets	3,208.00
Moveable Island	1,037.00
Cast Iron Sink	284.00
Crown Molding above Cabinets	127.00
Kitchen Desk	159.00
* GE Dishwasher	421.00
Casement Windows	1,579.00
* Crestine Walk-Out Bay (LR)	1,560.00
Upgrade Kit. Window	400.00
Suntube (Bath #2)	530.00
Poly. Skylights (x3)	1,485.00
Home Total w/Options	\$122,742.00

14 x 18 Sunroom w/Gable Base Price	\$16,331.00
Upgrade Carpet (WL)	291.00
Vaulted Ceiling	428.00
Paddle Fan w/Light	151.00
* Crestline Extra Windows	2,850.00
Sunroom Total w/Options	\$20,051.00

Total With Options Shown: \$142,793.00

Feb. 2009

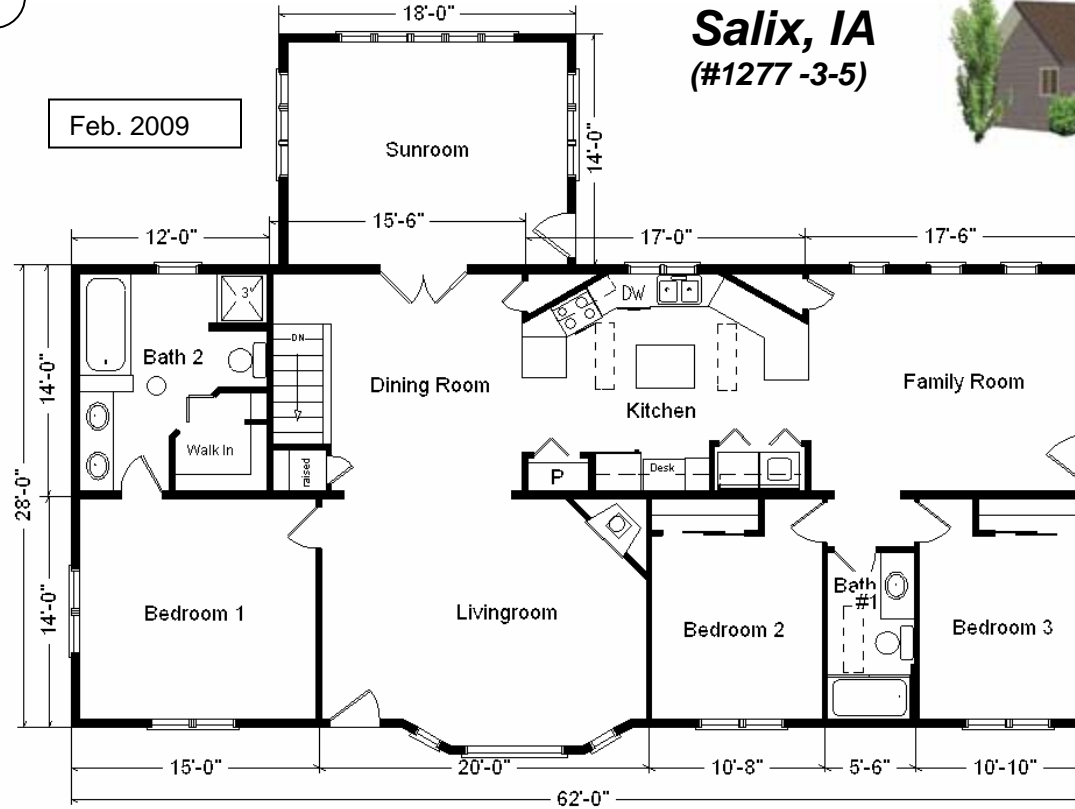

**Reverse Plan
 w/Optional
 Garage Shown**

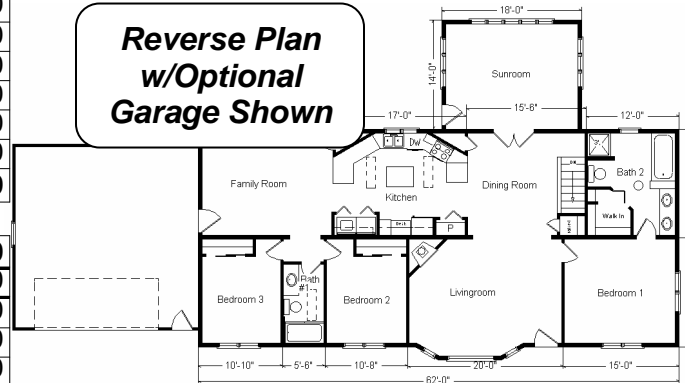

* Item/Brand Name No Longer Available

Color Information
 Nat. Clay Siding, Clay Trim, Horizon Green Shingles, Green Shutters, White & Bisque Baths, Mortar Carpet, 91056 Vinyls, 137734 Laminate Entry, 2413 Laminate in FR, SS Sink, Natural (old) Oak Trim & Doors, Bisque DW & Rangehood, Taupe Crestline Casement Windows, Melange Countertop

**Buy Display Model For:
 \$125,658.00!
 (discounted 17,135.00!)**

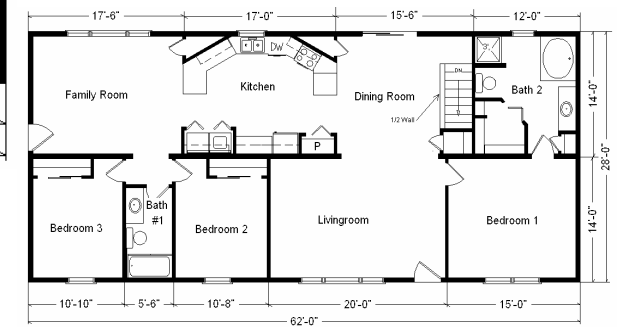

Variation...

Base Price:	\$ 94,314.00
With the most Popular Options:	
Whirlpool Dishwasher.....	439.00
Utility Hook-ups.....	395.00
6' Patio Door.....	481.00
¾ Bath.....	1,839.00
Garden Tub.....	769.00
Variation Total w/Options:..	\$98,237.00

Price Includes All Blueprints, Delivery, Crane Work, Water Heater, Finish Ready For Hookups, Lennox Furnace Installed, & Tax!